

# DATA SHEET



## Cat5e Non-Booted Unshielded (UTP) Ethernet Network Patch Cable

For network adapters, hubs, switches, routers, DSL/cable modems, patch panels and other high performance networking applications.

### OVERVIEW

For fast Ethernet computer networks that require bandwidth-intensive voice, data, or video distribution applications. Meets all Cat5e TIA EIA standards, and drastically reduces both impedance and structural return loss (SRL). Each of the individual pairs is bonded together to help maintain the twist-spacing throughout the line right up to the termination point. Constructed from high quality copper cable, this design minimizes Near-End Crosstalk (NEXT) levels. Available in a variety of colors to easily color-code your network installation.

### FEATURES

- Designed for network adapters, hubs, switches, routers and more
- Available in multi packs and in lengths up to 150ft
- Constructed with unshielded twisted pair wires
- CMG In-Wall Rated Jacket
- Available in 10 colors to color-code a network

### ITEM DESCRIPTION

Length	Gray	Blue	Black	Green	Red	Yellow	Orange	Purple	White	Pink
6in	00941	00942	00943	00944	00945	00946	00947	00948	00949	00950
1ft	24959	25462	26374	25070	25269	25623	00565	00586	27976	00617
2ft	24960	25151	00528	25515	00546	24669	00566	00587	00607	00618
3ft	22672	22673	22677	22674	22675	22676	00567	00588	23800	00619
4ft	00513	00520	00529	00537	00547	00556	00568	00589	00608	00620
5ft	22678	22679	22683	22680	22681	22682	00569	00590	25029	00621
6ft	00514	00521	00530	00538	00548	00557	00570	00591	00609	00622
7ft	22684	22685	22689	22686	22687	22688	00571	00592	23801	00623
8ft	00515	00522	00531	00539	00549	00558	00572	00593	00610	00624
9ft	00516	00523	00532	00540	00550	00559	00573	00594	00611	00625
10ft	22690	22691	22695	22692	22693	22694	00574	00595	25414	00626
12ft	00517	00524	00533	00541	00551	00560	00575	00596	00612	00627
14ft	22696	22697	22701	22698	22699	22700	00576	00597	25237	00628
15ft	22010	22709	22708	00542	00552	00561	00577	00598	00613	00629
20ft	00518	00525	00534	00543	00553	00562	00578	00599	00614	00630
25ft	22702	22703	22707	22704	22705	22706	00579	00600	23803	00631
30ft	00519	00526	00535	00544	00554	00563	00580	00601	00615	00632
35ft	25036	24896	25040	25038	25037	25039	00581	00602	27097	00633
50ft	24392	24393	24395	24394	24396	24397	00582	00603	23796	00634
75ft	24398	24399	24401	24400	24402	24403	-----	00604	22160	00635
100ft	24702	22161	26972	22162	26973	22164	00584	00605	23799	00636
150ft	24636	00527	00536	-----	00555	00564	00585	-----	00616	00637
200ft	24637	-----	-----	-----	-----	-----	-----	-----	-----	-----

designed to be better.™



# DATA SHEET

## SPECIFICATIONS:

### Cat5e Non-Booted Unshielded (UTP) Ethernet Network Patch Cable

#### ELECTRICAL SPECIFICATIONS:

- Conductor DC Resistance - 89Ω/km (maximum)
- Insulation Resistance - 100Ω/km (maximum)
- Dielectric Strength - 500MV/m
- Certification: TIA/EIA

#### CONDUCTOR (QTY. 4 TWISTED PAIR):

- Conductor Type - 24AWG (7/0.20), Stranded Bare Copper
- Insulation - H-D PE
- Diameter -  $0.95 \pm 0.02$ mm
- Colors - Blue, Blue-White, Orange, Orange-White, Green, Green-White, Brown, Brown-White

#### CONDUCTOR (QTY. 4 TWISTED PAIR):

- Jacket - FR-PVC
- Minimum Average Thickness - 0.55mm
- Outer Diameter -  $5.30 \pm 0.15$ mm

#### PHYSICAL SPECIFICATIONS:

- Wiring Scheme - TSB 568B (AT&T 258A)
- Approvals - RoHS Compliant
- Warranty - Lifetime
- Package Type - Polybag
- Jacket: PVC (CMG In-Wall Rated)

#### CONDUCTOR TYPE (QTY. 2):

- Connector Type - 8P8C (RJ45)
- Gender - Male
- Connector Material - Polycarbonate
- Contact Material - Copper Alloy, Gold Plating - 50μm

#### PRODUCT USES:

- 1000 BASE-T; 100 BASE-T; 10 BASE-T (IEEE 802.3)
- 4/16 Mbps Token Ring (IEEE 802.5); 100 VG-AnyLAN
- 100 Mbps TP-PMD (ANSI X3T9.5); 55/155 Mbps ATM
- Voice

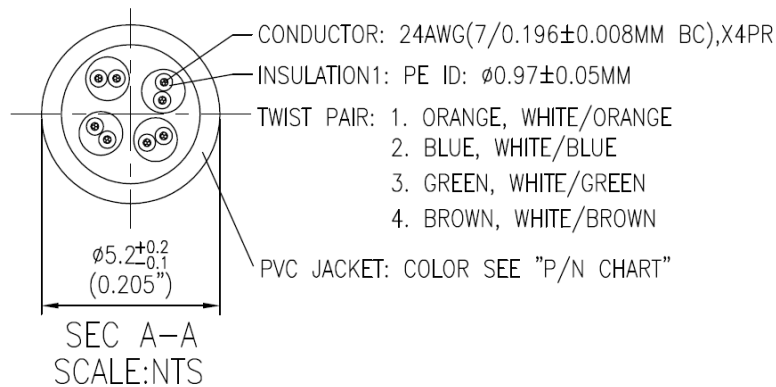
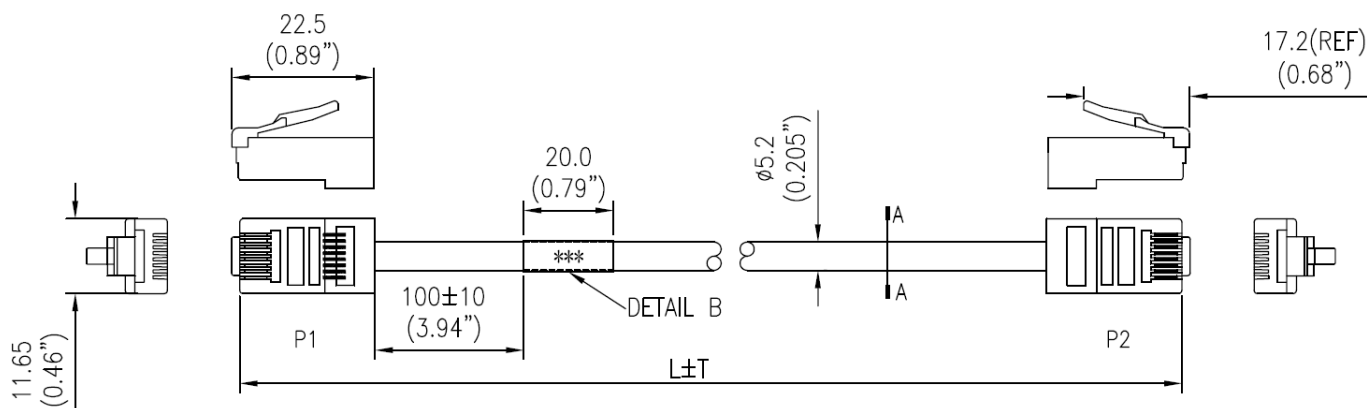

Legrand, North and Central America

60 Woodlawn Street  
 West Hartford, CT 06110  
 1.877.BY.LEGRAND (295.3472)  
 www.legrand.us